

*Located within Opportunity Zone*

**FOR LEASE OR SALE**

**865 South Washington**

SAN BERNARDINO, CA



## Washington Commerce Center

107,600 SF AVAILABLE

DEVELOPED BY:

**CROW HOLDINGS**  
CAPITAL

**REDA**  
REAL ESTATE DEVELOPMENT ASSOCIATES

**MIKE WOLFE**

Sr.VP/Partner  
909-373-2915  
Lic# 00641624  
mwolfe@lee-assoc.com

**CODY WOLF**

Senior Associate  
Lic. 01997598  
909.373.2916  
cwolf@lee-assoc.com

**JOE MCKAY**

Sr.VP/Partner  
909-373-2914  
Lic# 00894360  
jmckay@lee-assoc.com

**STEPHEN DEVERIAN**

Senior Associate  
909.373.2938  
Lic# 01964686  
sdeverian@lee-assoc.com

**CHRIS MORRELL**

Sr.VP/Partner  
909-373-2721  
Lic# 01410974  
cmorrell@lee-assoc.com

**LEE & ASSOCIATES**  
COMMERCIAL REAL ESTATE SERVICES

# Washington Commerce Center

# FOR LEASE OR SALE

## 865 South Washington

SAN BERNARDINO, CA



### Property Features:

- Located within Opportunity Zone
- 7", 4,000 PSI Floor Slab (Reinforced)
- 2% Skylights with Burglar Bars
- ESFR Sprinkler System
- Painted Interior Warehouse Walls
- White Scrim Foil Insulation
- All DH Doors Equipped with Z-Guards
- 1,200 Amp, 277/480 Volt Power (Exp to 4,000 Amps)

### 865 South Washington

Building Size (sf)	107,600
Land Size (Ac)	4.79
Min Clr Height	32'
Typical Bay Spacing	52' x 60'
# of DH Doors (9' x 10')	16
# of GL Doors (12' x 14')	1
Truck Court Width	130'
Car Parking Spaces	75
Office Area	Up to 5,000 SF

# Washington Commerce Center

# FOR LEASE OR SALE

**865 South Washington**

SAN BERNARDINO, CA

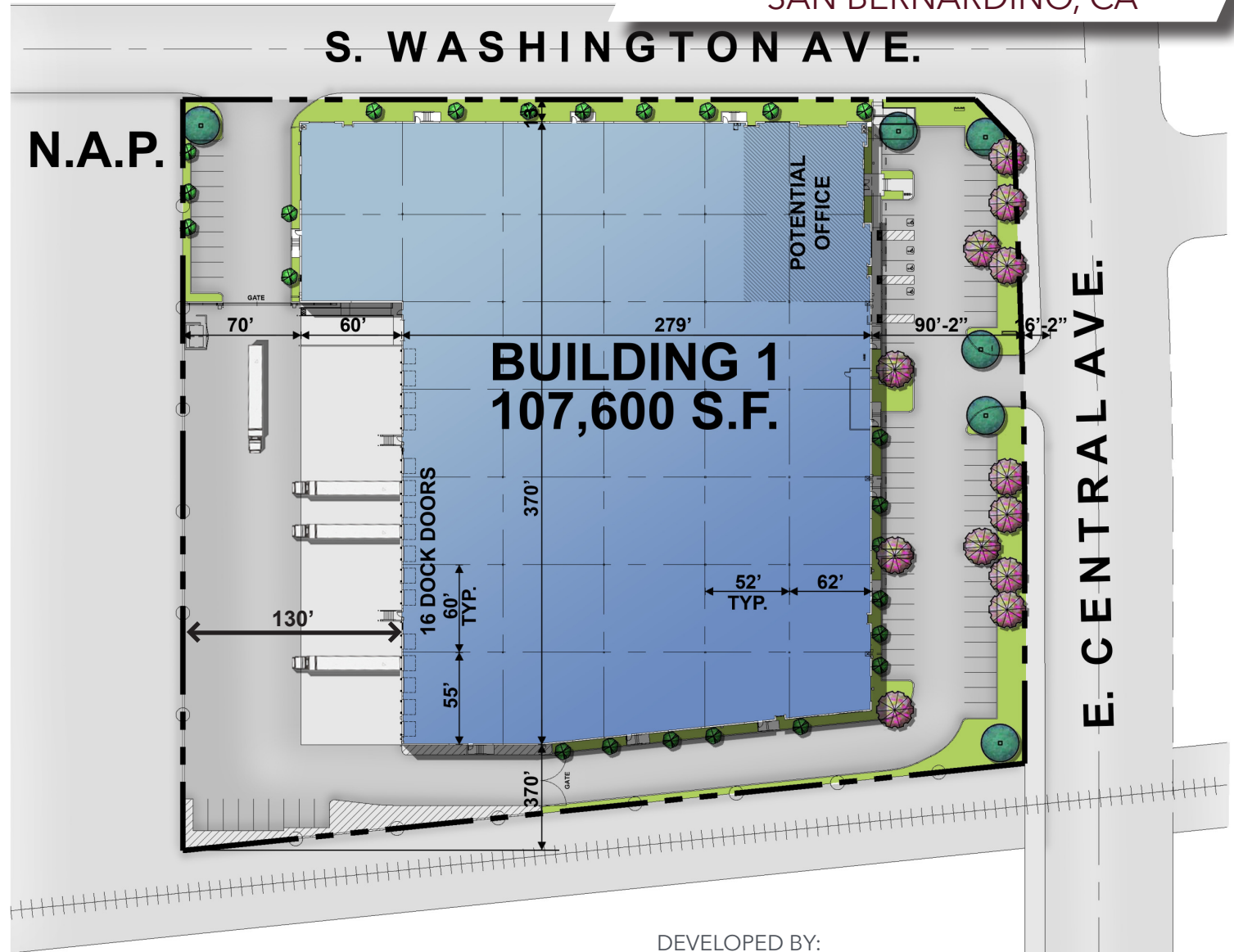

## MIKE WOLFE

Sr.VP/Partner  
909-373-2915  
Lic# 00641624  
mwolfe@lee-assoc.com

## JOE MCKAY

Sr.VP/Partner  
909-373-2914  
Lic# 00894360  
jmckay@lee-assoc.com

## CHRIS MORRELL

Sr.VP/Partner  
909-373-2721  
Lic# 01410974  
cmorrell@lee-assoc.com

## CODY WOLF

Senior Associate  
Lic. 01997598  
909.373.2916  
cwolf@lee-assoc.com

## STEPHEN DEVERIAN

Senior Associate  
909.373.2938  
Lic# 01964686  
sdeverian@lee-assoc.com



DEVELOPED BY:

**CROW HOLDINGS**  
CAPITAL



# Washington Commerce Center

# FOR LEASE OR SALE

## 865 South Washington

SAN BERNARDINO, CA

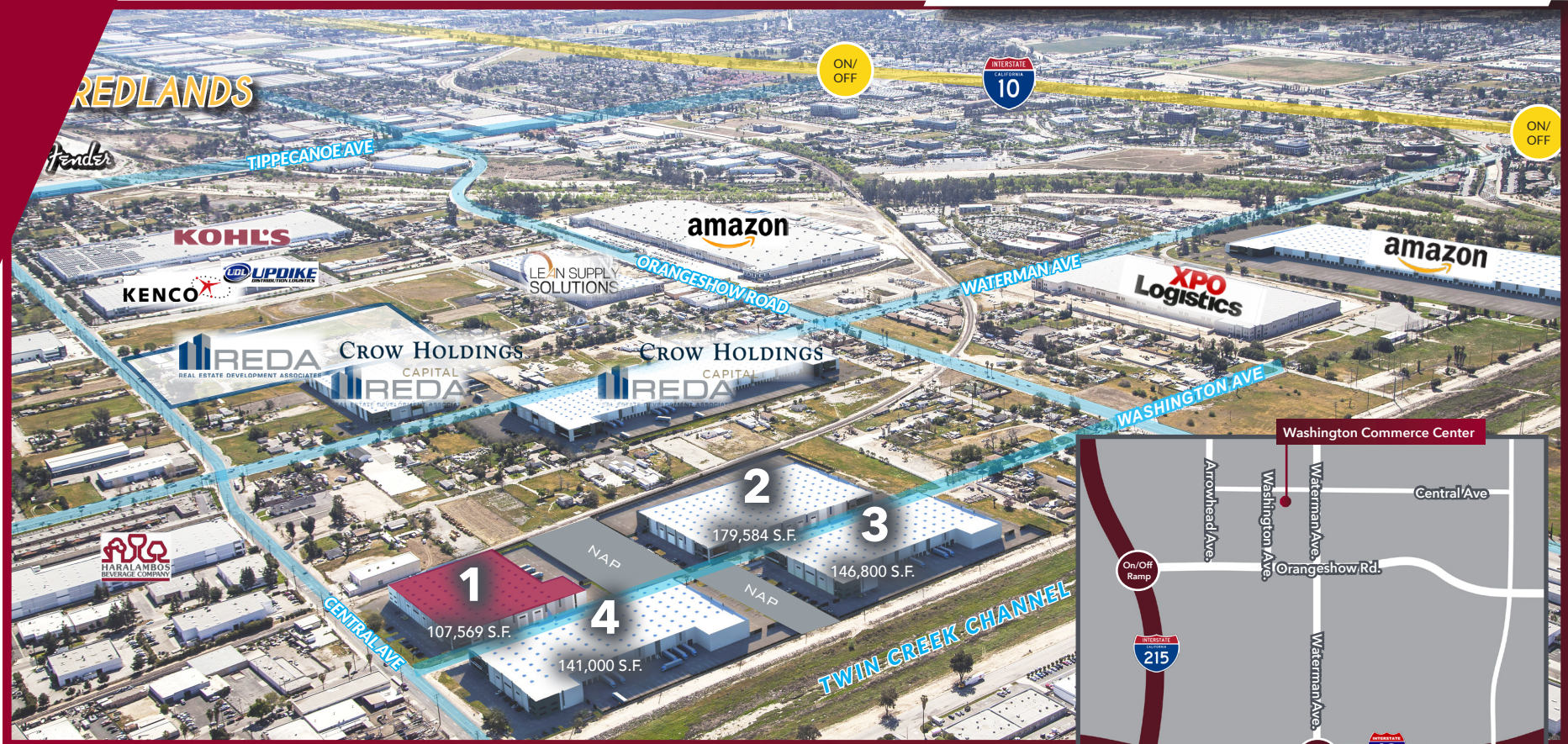

DEVELOPED BY:

**CROW HOLDINGS**  
CAPITAL

**REDA**  
REAL ESTATE DEVELOPMENT ASSOCIATES

**MIKE WOLFE**

Sr.VP/Partner

909-373-2915

Lic# 00641624

mwolfe@lee-assoc.com

**JOE MCKAY**

Sr.VP/Partner

909-373-2914

Lic# 00894360

jmckay@lee-assoc.com

**CHRIS MORRELL**

Sr.VP/Partner

909-373-2721

Lic# 01410974

cmorrell@lee-assoc.com

**CODY WOLF**

Senior Associate

Lic. 01997598

909.373.2916

cwolf@lee-assoc.com

**STEPHEN DEVERIAN**

Senior Associate

909.373.2938

Lic# 01964686

sdeverian@lee-assoc.com

**LEE & ASSOCIATES**  
COMMERCIAL REAL ESTATE SERVICES

All information furnished regarding property for sale, rental or financing is from sources deemed reliable, but no warranty or representation is made to the accuracy thereof and same is submitted to errors, omissions, change of price, rental or other conditions prior to sale, lease or financing or withdrawal without notice. No liability of any kind is to be imposed on the broker herein.